



Air for life

Technical Data Sheet

Flair 225

English



Contents

1 Scope of delivery.	3
1.1 Delivery size.	3
2 Technical specifications.	4
2.1 Technical information.	4
2.2 Connections and dimensions.	6
2.3 Appliance parts.	8
3 Service parts.	9
3.1 Exploded view.	9
3.2 Service articles.	10
3.3 Ordering service parts.	10
4 Conformity declaration.	11
5 ERP values	12
6 Recycling and disposal.	14

1 Scope of delivery

1.1 Delivery size

Before installation of the heat recovery appliance is started, check that it has been supplied in complete and undamaged condition.

The delivery size of the heat recovery appliance type Flair 225 consists of the following components:

1. Heat recovery appliance
2. Wall mounting bracket consisting of:
 - 1x mounting bracket
 - 2x protective caps
 - 2x rubber strip
 - 2x rubber rings
3. Siphon
4. Documentation set consisting of:
 - 1x installation instructions
 - 1x occupant's instructions

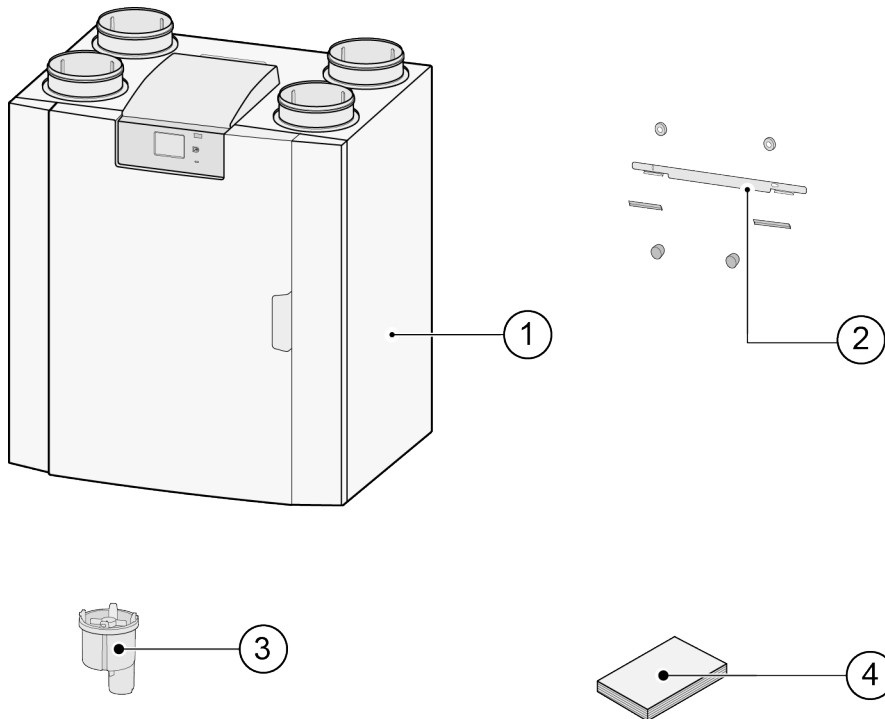

2 Technical specifications

2.1 Technical information

Flair 225										
Supply voltage [V/Hz]	230V/50Hz									
Dimensions (w x h x d) [mm]	600 x 650 x 455									
Duct diameter [mm]	ø125									
Ext. diameter condensate discharge [mm]	ø32									
Weight [kg]	29									
Filter class	ISO Coarse 60% (ISO ePM1.0 50% for the air supply optional)									
Fan setting (factory setting)	0		1		2		3		max	
Factory setting [m³/h]	40		50		100		150		225	
Permissible resistance of duct system [Pa]	3	8	5	12	20	49	44	111	100	250
Rated power (excl. preheater) [W]	7.9	8.3	8	8.7	13.2	17.3	26.2	37.9	61.5	92.2
Rated current (excl. preheater) [A]	0.10	0.11	0.10	0.10	0.13	0.16	0.22	0.32	0.48	0.70
Max. rated current (incl. preheater on) [A]	3.8									
Rated power internal preheater [W]	750									
Cos φ	0.336	0.34	0.357	0.363	0.447	0.460	0.507	0.521	0.522	0.572
WiFi Frequency range (OFR)	2400 MHz - 2483,5 MHz									
WiFi Max. power (EIRP)	<20 dBm (100 mW)									
Permitted ambient conditions	Between +2°C and +40°C. RH <90% non condensing									
Storage and transport conditions	Between -20°C and +45°C. RH <90% non condensing									
Permitted air temperature through appliance	Between -20°C and +45°C with standard internal pre-heater * Add an external pre-heater when the outside temperature is below -20°C for longer periods of time.									
Sound power										
Ventilation capacity [m³/h]				50	100	100	150	150	225	225
Sound power level Lw(A)	Static pressure [Pa]			25	25	50	50	100	100	150
	Casing radiation [dB(A)]			28	31	33.5	38.5	40.5	45.5	47
	Duct “From dwelling” [db(A)]			<30	<34.5	<36.5	44	43	47.5	48.5
	Duct ‘To dwelling’ [db(A)]			43.5	48.5	50.5	55	57.5	62.5	64.5

*) Duct noise including end correction

In practice the value may differ by 1dB(A) through measurement tolerances.

**Resistance
of duct
system
[Pa]**

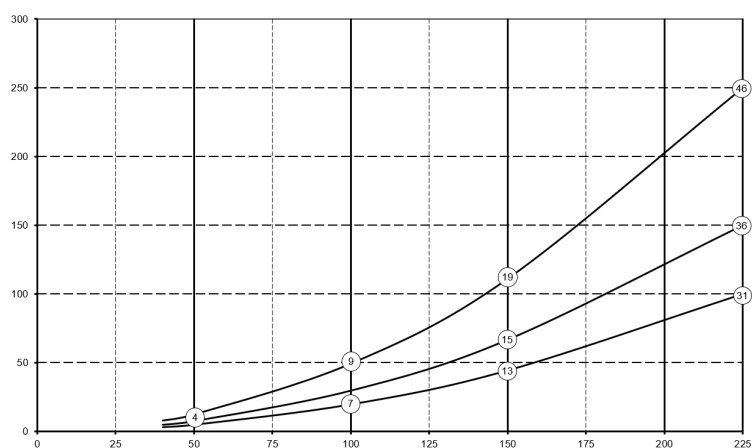

Flow rate [m³/h]

Note:

The stated value in the circle is the capacity (in Watt) per fan.



2.2 Connections and dimensions

The Flair appliance is available in a left-hand and right-hand version. With a left-hand version the “warm” connections (from dwelling 3 and to dwelling 1) are on the left-hand side of the appliance; the condensate discharge is then mounted at the right-hand opening below the appliance. With a right-hand version the “warm” connections (1 & 3) are on the right-hand side of the appliance.

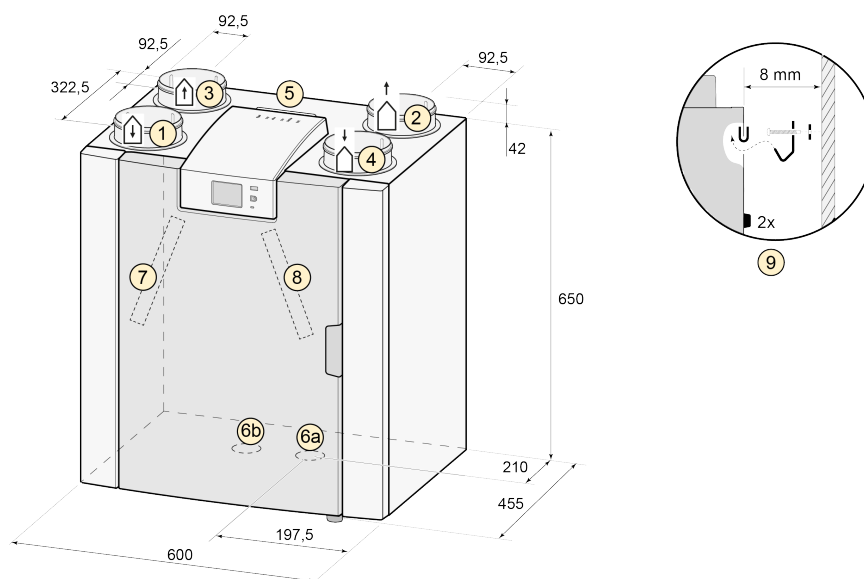
Left-hand version

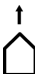

All dimensions in millimeters. Diameter of all collars is 125 mm

1	Supply air	
2	Exhaust air	
3	Extract air	
4	Outdoor air	
5	Electrical connections	
6a	Siphon connection	
6b	Sealing cap unused condensate discharge connection; do not remove!	
7	Extract air filter	
8	Supply air filter	
9	Mounting bracket	

Right-hand version

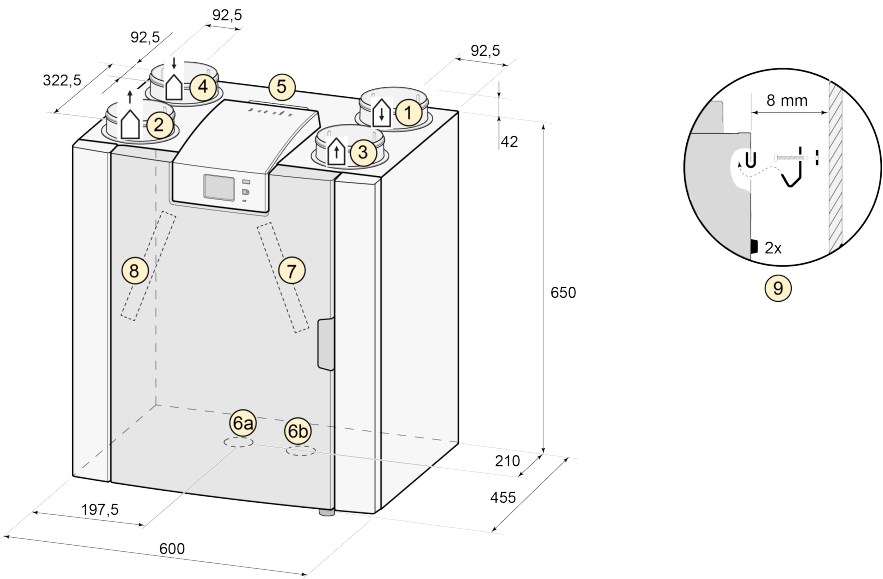

All dimensions in millimeters. Diameter of all collars is 125 mm

1	Supply air	
2	Exhaust air	
3	Extract air	
4	Outdoor air	
5	Electrical connections	
6a	Siphon connection	
6b	Sealing cap unused condensate discharge connection; do not remove!	
7	Extract air filter	
8	Supply air filter	
9	Mounting bracket	

2.3 Appliance parts

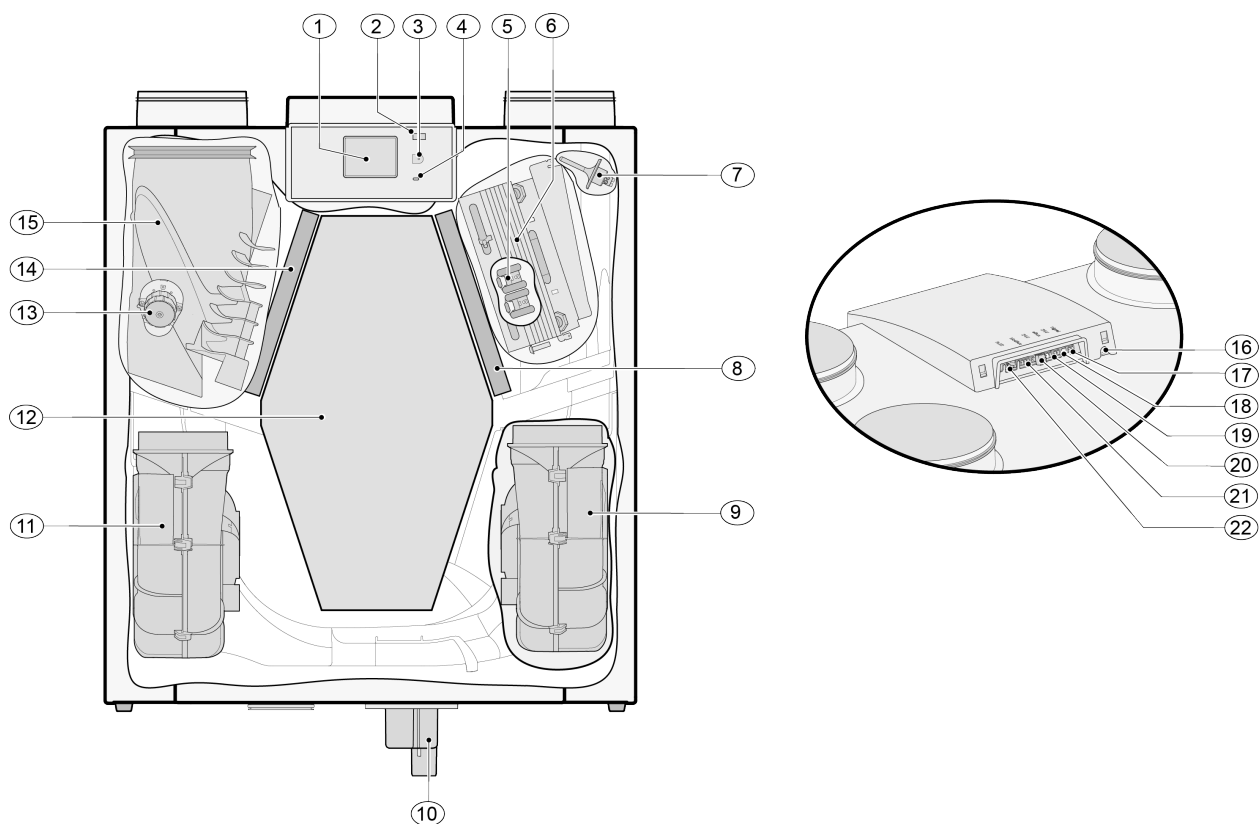

The appliance shown above is a left-hand version: in the case of a right-hand version, the connector of the preheater, bypass valve and the siphon connector are installed in mirror image!

1	Touchscreen	12	Heat exchanger
2	USB connector (X13)	13	Motor bypass valve
3	Service connector	14	Exhaust air filter
4	LED indicator	15	Bypass valve
5	Maximum protection preheater	16	Power cable 230 volt
6	Preheater	17	Relay output (X19)
7	Temperature sensor	18	24 volt connector (X18)
8	Supply filter	19	eBus connector (X17)
9	Exhaust fan	20	24 volt connector (X16)
10	Siphon / P-trap	21	Modbus/ Internalbus connector (X15)
11	Supply ventilator	22	Multiple switch connector (X14)

3 Service parts

3.1 Exploded view

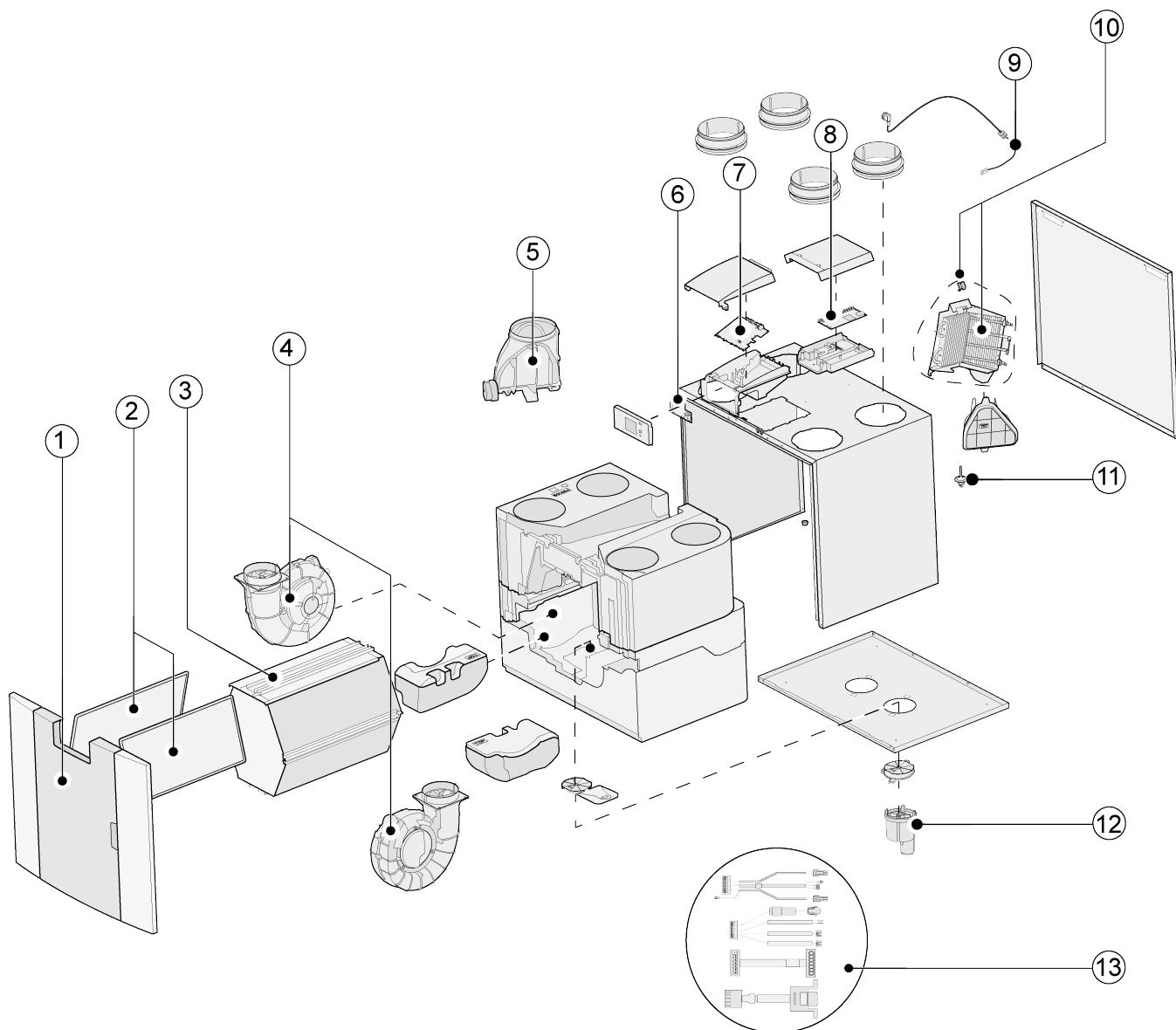

Danger

The power cable is fitted with a circuit board connector. When replacing it, always order a replacement mains cable from Brink.

To prevent dangerous situations, a damaged mains connection can only be replaced by a qualified expert.

3.2 Service articles

No.	Article description	Article code
1	Front panel complete	532799
2	Filters (2 items) ISO Coarse 60%	532811
3	Heat exchanger	532795
4	Fan (1 item)	532803
5	Bypass valve with motor complete	532797
6	Display pcb UBP-2	532752
7	Appliances manufactured before 01-01-2023 : Basic pcb UWA2-B + display	532750
	Appliances manufactured after 01-01-2023 : Basic pcb UWA2-B	532966
8	Plus pcb UWA2-E (only applicable with Plus version)	532751
9	Mains plug and cable 230 V	532756
10	Internal preheater incl. maximum security	532798
11	Temperature sensor NTC 10K	531775
12	Condensation discharge	532762
13	Cable set	532767

3.3 Ordering service parts

When ordering parts, in addition to the article code number (see exploded view), please state the heat recovery appliance type, the serial number, the year of production and the name of the part:



Note

Appliance type, serial number and year of production are stated on the identification plate behind the plastic front panel on the appliance.

Example	
Appliance type	Flair 225 (Plus)
Serial number	428000220201
Year of production	2024
Part	Fan
Article code	532803
Quantity	1

4 Conformity declaration

This declaration of conformity is issued under the sole responsibility of the manufacturer.

Manufacturer: **Brink Climate Systems B.V.**

Address: **Postbus 11**
 NL-7950 AA, Staphorst, The Netherlands

Product: **Flair 225**
 Flair 225 Plus

The product described above complies with the following directives:

- | | |
|-------------------|-----------------------------|
| ◆ 2014/35/EU | (OJEU L 96/357; 29-03-2014) |
| ◆ 2014/30/EU | (OJEU L 96/79; 29-03-2014) |
| ◆ 2009/125/EU | (OJEU L 285/10; 31-10-2009) |
| ◆ 2017/1369/EU | (OJEU L 198/1; 28-07-2017) |
| ◆ RoHS 2011/65/EU | (OJEU L 174/88; 01-07-2011) |

The product described above has been tested according to the following standards:

- | | |
|---------------------|---|
| ◆ EN IEC 55014-1: | 2021 |
| ◆ EN IEC 55014-2: | 2021 |
| ◆ EN IEC 61000-3-2: | 2019 + A1:2021 |
| ◆ EN 61000-3-3: | 2013 + A1:2019 + A2:2021 |
| ◆ EN 60335-1: | 2012 + AC:2014 + A11:2014 + A13:2017 + A1:2019 +
A2:2019 + A14:2019 + A15:2021 |
| ◆ EN 60335-2-40: | 2003 + A11:2004 + A12:2005 + AC:2006 + A1:2006 +
A2:2009 + AC:2010 + A13:2012 |
| ◆ EN 62233: | 2008 + AC:2008 |

Staphorst, 07-06-2023

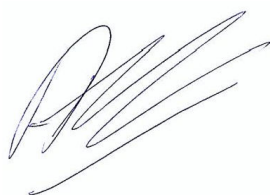

A. Hans
Director

5 ERP values

Technical information sheet Flair 225 in accordance with Ecodesign (ErP), no. 1254/2014 (Annex IV)					
Manufacturer:		Brink Climate Systems B.V.			
Model:		Flair 225			
Climate zone	Type of control	SEC Value in kWh/m ² /a	SEC Class	Annual electricity consumption (AEC) in kWh	Annual heating saved (AHS) in kWh
Average	manual	-40,68	A	258	4646
	clock control	-41,33	A	237	4658
	1x sensor (RV/CO ₂ /VOC)	-42,54	A+	199	4684
	2 or more sensors (RV/CO ₂ /VOC)	-44,65	A+	135	4735
Cold	manual	-79,74	A+	795	9088
	clock control	-80,50	A+	774	9113
	1x sensor (RV/CO ₂ /VOC)	-81,96	A+	736	9163
	2 or more sensors (RV/CO ₂ /VOC)	-84,56	A+	672	9263
Hot	manual	-15,68	E	213	2101
	clock control	-16,26	E	192	2106
	1x sensor (RV/CO ₂ /VOC)	-17,33	E	154	2118
	2 or more sensors (RV/CO ₂ /VOC)	-19,16	E	90	2141
Type of ventilation unit:		Balanced residential ventilation appliance with heat recovery			
Fan:		EC - fan with infinitely variable control			
Type of heat exchanger:		Recuperative plastic cross-counterflow heat exchanger			
Thermal efficiency		92 %			
Maximum flow rate:		225 m ³ /h			
Maximum rated power:		118 W			
Sound power level L _{wa} :		39 dB(A)			
Reference flow rate:		158 m ³ /h			
Reference pressure:		50 Pa			
Specific Power Input (SEL):		0.17 Wh/m ³			
Control factor:		1.0 in combination with multiple position switch			
		0.95 in combination with clock control			
		0.85 in combination with 1 sensor			
		0.65 in combination with 2 or more sensors			
Leakage*	Internal	0.70 %			
	External	1.80 %			
Position dirty filter indication:		On the display of the appliance / on the multiple position switch (LED) / on the Brink Air Control. Attention! For optimal energy efficiency and a proper operation, a regular filter inspection, cleaning or replacement is necessary.			
Internet address for Assembly instructions:		https://www.brinkclimatesystems.nl/support/downloads			
Bypass:		Yes, 100% Bypass			

* Measurements executed by TZWL according to the EN 13141-7 standard

Classification from 1 January 2016	
SEC class ("Average climate zone")	SEC in kWh/m²/a
A+ (Most efficient)	SEC < -42
A	$-42 \leq \text{SEC} < -34$
B	$-34 \leq \text{SEC} < -26$
C	$-26 \leq \text{SEC} < -23$
D	$-23 \leq \text{SEC} < -20$
G (Least efficient)	$-20 \leq \text{SEC} < -10$

6 Recycling and disposal



Do not dispose of as household waste!

In accordance with the Waste Disposal Act, the following components must be disposed of or recycled in an environmentally compatible manner by means of appropriate collection points:

- Old appliance
- Wearing parts
- Defective components
- Electrical or electronic waste
- Environmentally hazardous liquids and oils

Environmentally compatible means separated by material groups to ensure the greatest possible recyclability of the basic materials with the minimum environmental impact.

1. Dispose of packaging made of cardboard, recyclable plastics and synthetic filler materials in an environmentally compatible manner through appropriate recycling systems or a recycling center.
2. Please observe the applicable national and local regulations.

Brink Climate Systems B.V.

Wethouder Wassebaliestraat 8, NL-7951SN Staphorst

T: +31 (0) 522 46 99 44

E. info@brinkclimatesystems.nl

www.brinkclimatesystems.nl